

The oil valve 29551 which is used on the Efel/Nestor Martin oil stoves with an 8 inch burner can be replaced with a similar valve 29551A which has a slightly different flow rate.

The original valve is 5.5cc to 17.5cc and the one we can supply is 4.2cc to 15.8cc

The valve will need the flow rates increasing to suit the 8 inch burner. To do this the high and low fire screws will need to be adjusted anticlockwise.

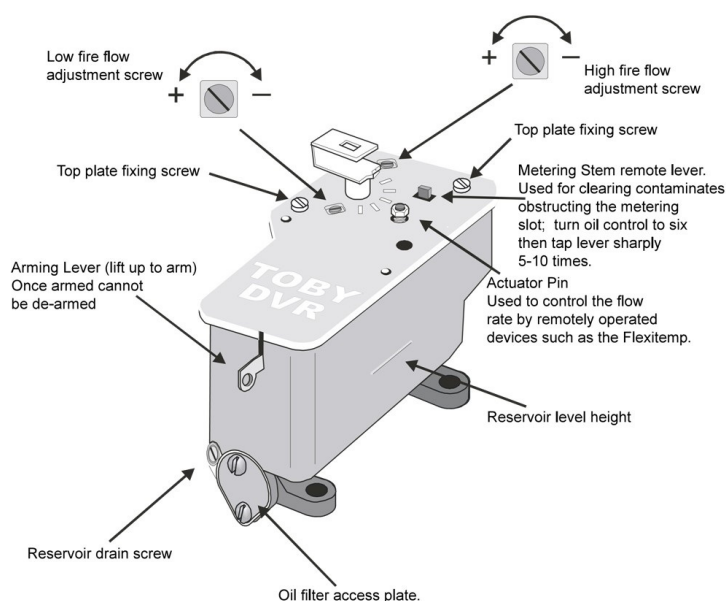

When fitting the valve ensure that the pipe top the burner is clear of any carbon build up by blowing it through. Also ensure that the tee piece on the de-coke inlet pipe is clear of any carbon and that the de-coke rod is moving freely up and down the tube. If not remove the whole assembly with a 22mm spanner and clear out any carbon in there. This in most cases is the reason for poor oil flow from a Toby valve to the burner.

Once the valve has been fitted the stove should be lit with the oil control set in the mid position until the flue has warmed up and the oil is burning as a blue flame. If it is still burning orange then increase the control until it does burn blue with a flue draught of 0.035inches H2O or 7.5 PA. This can take up to 20 minutes depending on the flue it is installed into.

Turn the oil control knob down to the minimum position which is the resistance before it goes click off.

Observe the flame and if it starts to go orange and sooty burning from where the oil enters the burner increase the low fire screw, anticlockwise, until the flames turn back to blue and stabilise in the low fire setting, see the picture below.

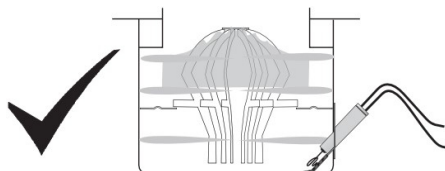

Once the low fire has been set you can ask the customer if they ever run the stove above halfway on the control dial. If they don't then you need not bother increasing the high fire screw.

If they do run it on maximum for a time then turn anticlockwise the high fire screw until the top of the flames are level with the top of the glass on the door. The flames should not hit the roof of the firebox as this will cause the flames to chill and produce soot.

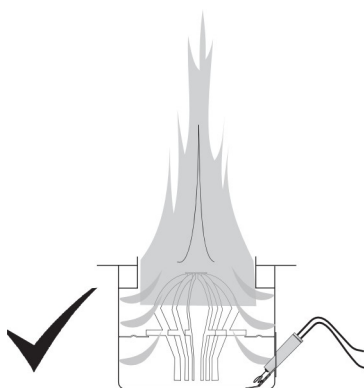

Once both low and high fire have been established check all the joints to ensure there are no leaks.

Original Toby with brass effect



Toby valve as supplied today

